

COMPRESSION FITTINGS

Nut - RO E

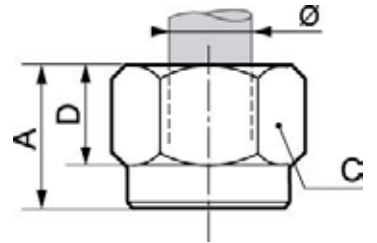

60

Min. / Max temperature

-40 / 240 °C

Part number	Dim. A (mm)	Dim. C (mm)	Dim. D (mm)
RO E4	11	10	8
RO E6	11.5	12	9
RO E8	13	14	10
RO E10	15.5	19	14
RO E12	15.5	22	14